

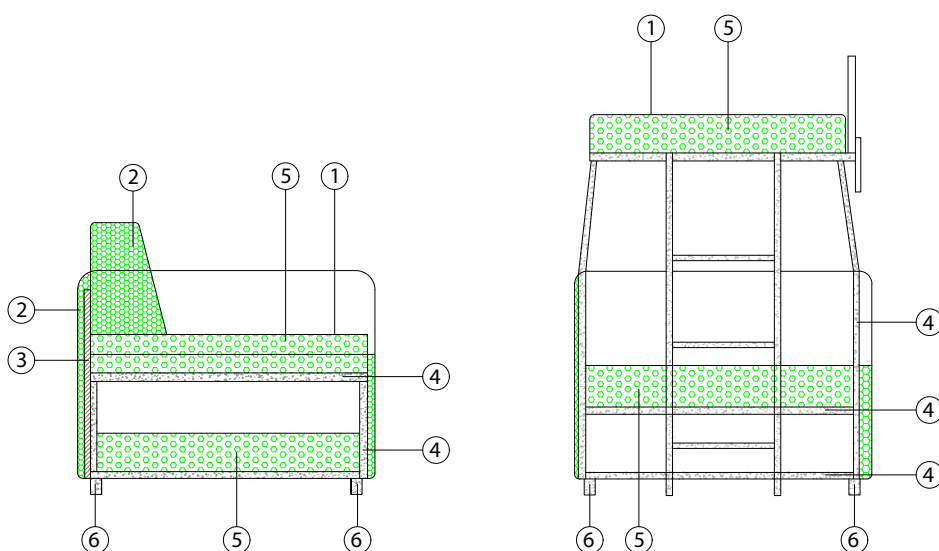

# ERA



Turn a sofa into a bunk bed in the blink of an eye. Era is equipped with a light, sliding mechanism, whose fastening systems guarantee it will hold steady once opened. It also features a practical ladder to climb onto the upper bed. It should be placed close to a wall, as, once opened, the upper bed features a parapet on one side only.



- 1- fabric/leather;
- 2- high resiliency polyurethane foam of different densities and dacron® fiber 100 gr layer;
- 3- structural frame in composite wood;
- 4- high-resistance steel electro-welded opening mesh with vertical lift

- assisted by special springs;
- 5- fire retardant or standard polyurethane mattress, with two-fold mechanism, h 12/13 cm, covered with antiallergic polyester lining.
- 6- steel feet.





# ERA

## DIMENSIONS

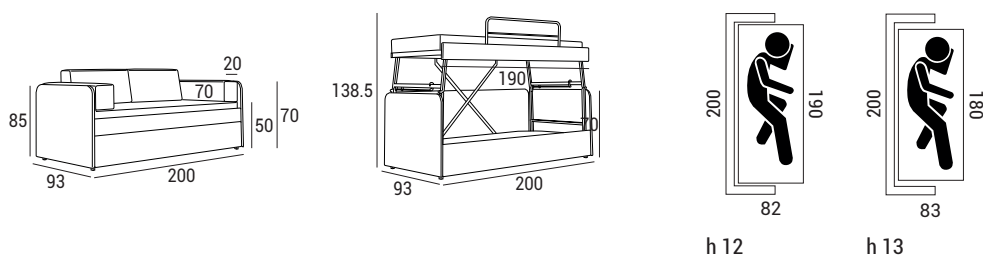

## SOFA BED

### Opening

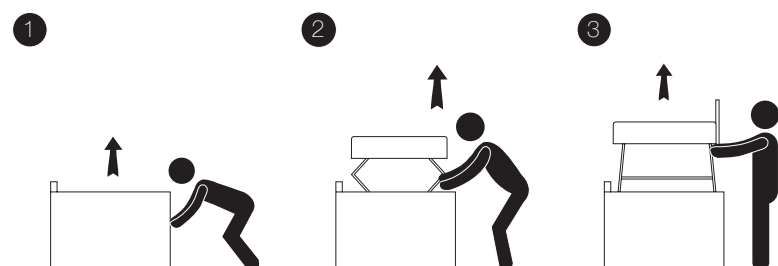

Opening folding the bed incorrectly could damage the mechanism

Before opening or closing make sure you are blocked or unlocked the double block system for safety block.

### Closing

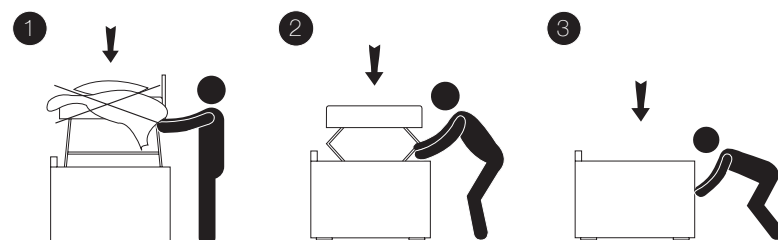

REMOVE all sheet, blankets and pillows before folding the sofa back up to avoid breaking the mechanism

## SECURITY SYSTEM

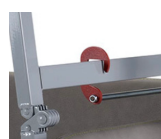

Double block system for safety lock, which is placed at the mechanism frame. Additional sliding block of the rear cross.

## INFORMAZIONI TECNICHE

			 fabric mtl H 140 cm	 leather m <sup>2</sup>
ERA	88	1.62	11.50	21.39